

## \* PREFACE \*

When it becomes necessary to replace parts on SUZUKI MOTORCYCLES, always use SUZUKI GENUINE PARTS which have passed a strict inspection which guarantees quality and performance.

This parts catalogue covers the list of all service parts for SUZUKI GSX-R1000K3, GSX-R1000K4.

## INSTRUCTIONS FOR QUOTING THE CATALOGUE

## 1. DIMENSIONS

Dimensions of the parts in this catalogue are indicated in unit millimeters.

## 2. ABBREVIATIONS

Abbreviations used in this catalogue are as follows:

AR	: As required	NT	: Number of teeth
ASSY	: Assembly	OPT	: Optional
E. No.	: Engine number	OS	: Over size
F. No.	: Frame number	STD	: Standard
d	: Diameter of material	T	: Thickness
ID	: Inside diameter	US	: Under size
OD	: Outside diameter	W	: Width
L	: Length	E28	: Canada specification
LH	: Left hand side	E3	: Federal specification
RH	: Right hand side	E33	: California specification

~100045 : Up to F.No.100045

100046~ : From F.No.100046

12 x 34 x 5.6 -----Figures in the description column

|    |    |                    show the dimensions of parts.

ID    OD    T(or W, L)

## 3. INNER PARTS OF ASSEMBLY

Part name with a dot (.) in front as shown in the description column indicates the component of the assembly also available individually.

## 4. MODIFICATION NOTICE

A parts bulletin will be sent to you on all occasions when changes in parts occur, including interchangeable modifications between new parts and old ones.

## 5. NOTE

5-1. There are some different parts from those of production models among spare parts for the administrative reasons and common use of them with other models.

5-2. In respect of rubber hoses and vinyl tubes, please be sure to use them by cutting off according to the length mentioned on parts catalogue or what is actually required on the vehicle.

5-3. Note that the drawings on the illustration page are for ready reference of spare parts number, not to be used as an assembly manual.

When assembling, use "SUZUKI SERVICE MANUAL".

## 6. SERIAL FRAME NUMBER

GSX-R1000K3 : JS1GT75A 32100001~

GSX-R1000K4 : JS1GT75A 42100001~

# MILLIMETER - INCH CONVERSION CHART

	0	1	2	3	4	5	6	7	8	9
00	.000	.039	.079	.118	.157	.197	.236	.276	.315	.354
10	.394	.433	.472	.512	.551	.591	.630	.669	.709	.748
20	.787	.827	.866	.906	.945	.984	1.024	1.063	1.102	1.142
30	1.181	1.220	1.260	1.299	1.339	1.378	1.417	1.457	1.496	1.535
40	1.575	1.614	1.654	1.693	1.732	1.772	1.811	1.850	1.890	1.929
50	1.969	2.008	2.047	2.087	2.126	2.165	2.205	2.214	2.283	2.323
60	2.362	2.402	2.441	2.480	2.520	2.559	2.598	2.638	2.677	2.717
70	2.756	2.795	2.835	2.874	2.913	2.953	2.992	3.031	3.071	3.110
80	3.150	3.189	3.228	3.268	3.307	3.346	3.386	3.425	3.465	3.504
90	3.543	3.583	3.622	3.661	3.701	3.740	3.780	3.819	3.858	3.898

	0	1	2	3	4
00	---	---	---	---	---
10	---	---	---	---	---
20	---	---	---	0.906	---
30	---	---	---	---	---

23 millimeters equal 0.906 inch.

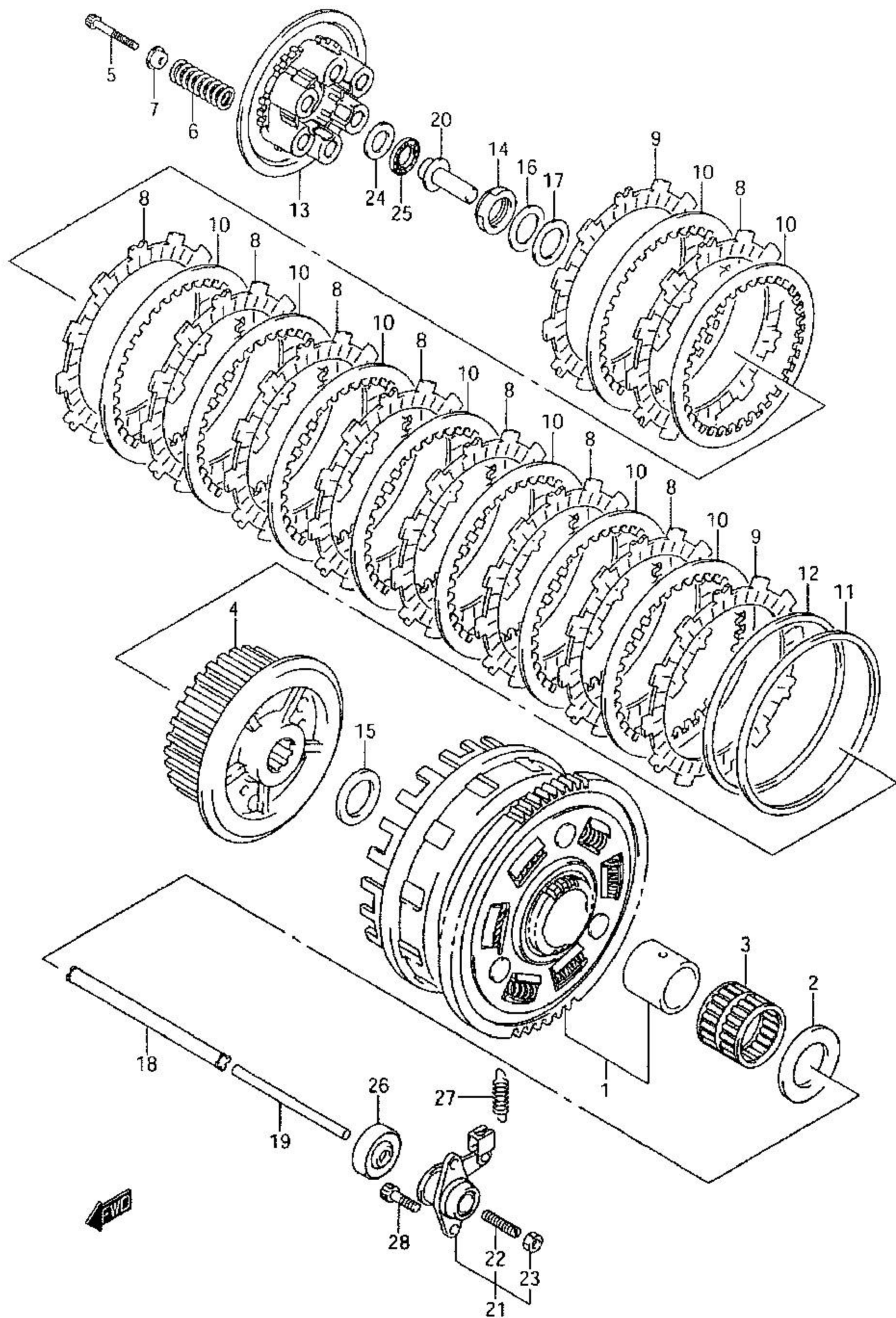



## COLOR CODE CHART

<u>CODE</u>	<u>COLOR</u>	<u>CODE</u>	<u>COLOR</u>
ABF	0AT,YBA	MZ9	YCF,YDC
AGR	019,YU8	NA1	YCF,YDC,YC8
AKP	YBB,Y7L	YAP	MAT SHADOW BLACK METALLIC
AKR	YBB,Y7L,YCF,019	YAV	BURNING COPPER METALLIC
AKS	019,YU8,YCF	YBA	SUZUKI DEEP BLUE NO.2
AKT	YD8,YU8,YCF,019	YBB	MEDIUM BLUE NO.2(PEARL)
AKU	YBD,YFJ	YBD	SPLASH WHITE
AKV	019,YFK	YCF	LUMINOUS ORANGE NO.3
AKW	019,YDC	YC8	CHROME BLACK
ALM	YD8,YFJ	YDC	CHROME SILVER (TAPE)
ASJ	YGP,YU9	YD8	SONIC SILVER METALLIC
CT5	YD8,019	YFJ	CARBON
E9Y	0AT,019	YFK	CARBON
FP2	YD8,Y7L	YFL	TAPE SET,GSXR1000,FOR,W/BU
HT6	YC8,YD8	YFM	TAPE SET,GSXR1000,FOR,Y/B
LA1	YD8,YU8	YFN	TAPE SET,GSXR1000,FOR,GL/B
LB4	019,YD8	YGP	HAIR LINE CHROME BLACK NO.3
LR5	YBA,YBD	YU8	FLINT GRAY METALLIC
LR8	019,YAV	YU9	PEARL ORPIMENT YELLOW
LS3	YBB,YBD	Y7L	SATURN BLACK METALLIC
LW8	YBA,YBD,YBB	ZTX	GRAY METALLIC
MW2	YBD,019	0AT	SILVER
MZ3	YBD,YU8,019,YCF	019	BLACK
MZ4	YAV,YD8,019,YCF	163	PHLOLINA YELLOW
MZ5	YBD,YC8	291	BLACK (SEMI-GLOSS)
MZ6	YAV,YC8	5ES	OFF BLACK
MZ7	YD8,YU8,Y7L	5PK	BLACK
MZ8	YCF,YC8	6BY	BLACK

**\*\* NOTE: FOR PAINT INQUIRIES PLEASE CALL COLOR-RITE AT (800) 736-7980**

